

SureSeal S/Steel Slim Single Door Wafer Non-Return Check Valve

SIZE	L	D	φ		Weight kg/pc
			PN10	PN16	
1"	14	11.5	71		0.5
1.25"	14	17	82		0.6
1.5"	14	22	92		0.75
2"	14	32	107		0.85
2.5"	14	40	127		1.2
3"	14	54	142		1.4
4"	18	70	162		2.5
5"	18	92	192		2.8
6"	20	114	218		4.2
8"	22	154	273		6.9
10"	26	200	328	329	12.5
12"	28	235	378	384	17.5
14"	38	280	438	444	30
16"	44	316	489	491	41
18"	50	360	532	550	66
20"	56	405	585	610	91
24"	62	486	690	724	138

1. Valve design according to ASME B16.34.
2. Flanges according to DIN2501 .
3. Face-to-Face according to client request, not standardized.
4. Valve inspection and testing according to API598-2004 .

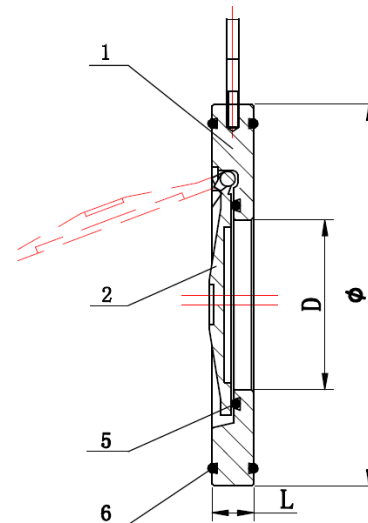
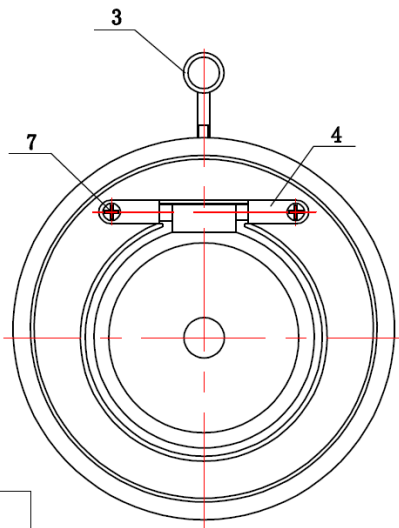

PARTS LIST

No.	NAME	MATERIAL	QTY.	REMARK
1	BODY	CF8M WCB	1	
2	DISC	CF8M WCB	1	
3	RING	WCB	1	
4	FEMNO	SS316 WCB	2	
5	INNER GASKET	NBR EPDM VITON PTFE	1	
6	OUTER GASKET	NBR EPDM VITON PTFE	2	
7	BOLT	SS316 WCB	2	

					SINGLE DISC SWING CHECK VALVE	ZHF-DB-00-01						
					ASSEMBLY DRAWING	<table border="1" style="font-size: 0.8em;"> <tr> <td style="width: 30px;">ALL SHEET</td> <td style="width: 30px;">WEIGHT</td> <td style="width: 30px;">SCALE</td> </tr> <tr> <td>SHEET OF</td> <td></td> <td></td> </tr> </table>	ALL SHEET	WEIGHT	SCALE	SHEET OF		
ALL SHEET	WEIGHT	SCALE										
SHEET OF												
MARK	QTY.	PAPT No.	BY	DATE								
DEG												
CHK												
APP												

Property Specifications:

1. Working pressure: 1.6Mpa
2. Pressure closure test pressure: 1.76Mpa
3. Shell pressure test pressure: 2.4Mpa
4. Working temperature : for CF8M:-20°C ~+135°C for WCB:0°C ~+135°C