

# Series 42TL

## Tank Level Sensor

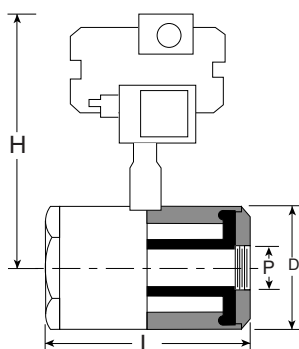

- ▶ Accurate, dependable level readings  $\pm 2"$
- ▶ Can be flushed or rodded clean without removing from tank or disassembling
- ▶ Full 360° pressure reading
- ▶ Integral LED display available
- ▶ Simple design
- ▶ Available for both vented and pressurized tanks
- ▶ 4-20 mA output



The Red Valve Tank Level Sensor is not affected by foaming, ice and other conditions that can cause errors in ultrasonic and capacitance level sensors. The Red Valve Tank Level Sensor uses a high sensitivity, solid state pressure transmitter that is completely isolated from the process fluid by an elastomer sleeve that transmits pressure through a fluid fill.

The pressure transmitter is available to sense gauge pressure for vented tanks and differential pressure for pressurized tanks. It can easily be calibrated for process fluid density or specific gravity in any height of tank. The output signal is 4-20 mA. An integral LED display is available and can be calibrated in virtually any units, e.g. percentages, inches H<sub>2</sub>O, etc.

The elastomer diaphragm provides maximum surface area with minimum diameter, allowing installation close to the bottom of the tank. The sensor can be "rodded" from the outside of the tank to the inside of the tank in the event of a severe blockage. A flange connection is also available.

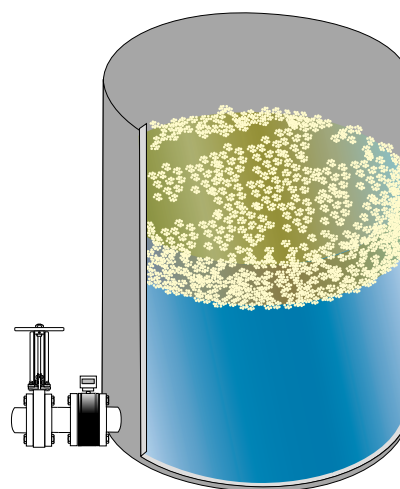

### Materials of Construction

- ▶ **BODY and FLANGES**  
Carbon steel, optional 316 stainless steelP
- ▶ **Elastomer Diaphragm**  
Buna-N, EPDM, Viton®, food grade rubberP
- ▶ **Fill Fluid**  
Silicone oil

### DIMENSIONS SERIES 42TL

SENSOR SIZE	P PIPE THREADED	D BODY DIA	L BODY LENGTH	H HEIGHT
2"	2"NPT	4"	7"	9.5"
3"	3"NPT	5"	9.44"	10"

