

Ball Valve 2-PC CF8M S/Steel 150# Flanged Undrilled

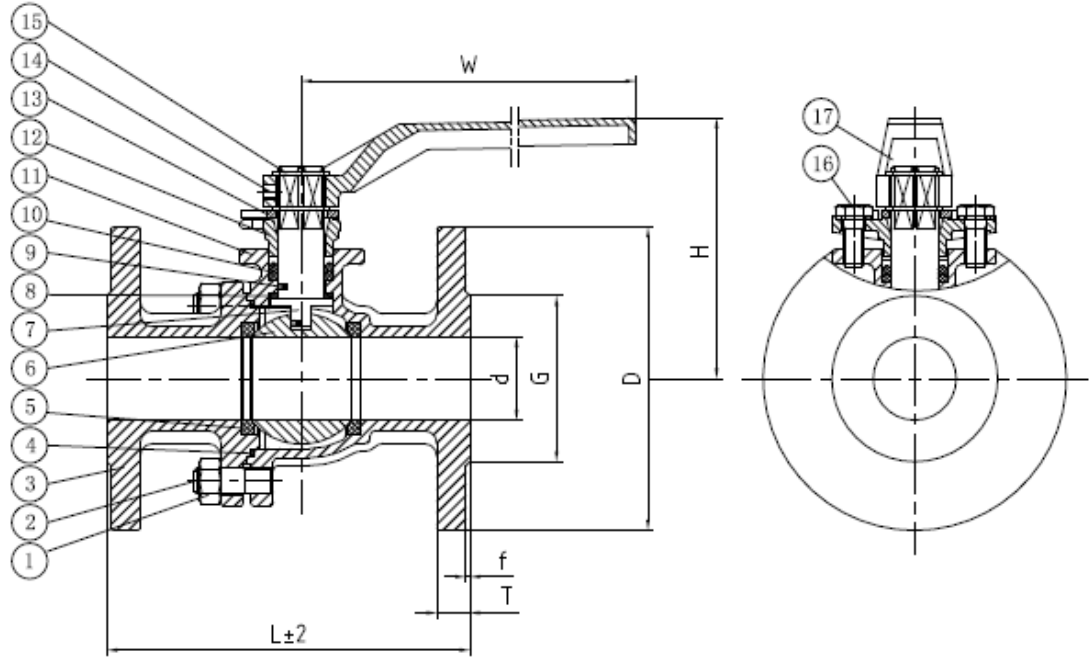

Main Technical Parameter			
Normal Pressure		150	lb
Test Pressure	Shell test Pressure	3.0	Mpa
	Tightness	2.2	
	Gas Tightness Test	0.6	
Max Working Temperature		-20~150	°C
Applicable Medium: Water, Gas, Oil, Acid			

MAIN SIZE											units: mm
Size	½"	¾"	1"	1¼"	1½"	2"	3"	4"	6"	8"	10"
d	15	20	25	32	38	50	78	100	150	200	250
L	108	117	127	140	165	178	203	229	394	457	533
D	95	105	115	140	150	165	200	220	285	340	405
G	45	58	68	78	88	102	138	158	212	268	320
f	2	2	2	2	3	3	3	3	3	3	3
T	14	16	16	16	16	18	20	20	22	24	26
H	77.5	79	88	100	122	130	167	188	278	329	395
E	150	150	150	170	230	230	305	305	645	845	1335
°P	11	11	11	14	17	17	22	22	27	27	36
ISO5211	F4	F4	F4	F5	F7	F7	F10	F10	F12	F12	F14
Weight(kg)	2	2.2	3	4.6	6.2	9	15	19	47	81	180
Torque(Nm)	4.5	7	8.5	14.5	21	28	86	121	234	1015	1470

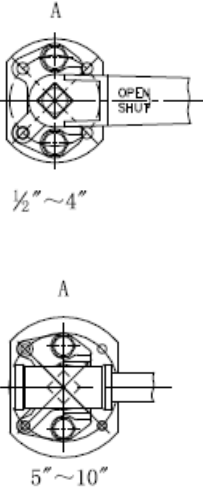

MAIN PARTS MATERIALS		
No.	Part Name	Material
01	Nut	A194-8
02	Bolt	A193-B8
03	Cap	A351 CF8M
04	Joint Gasket	PTFE
05	Seat	PTFE
06	Ball	SS316
07	Stem	A276 SS316
08	Thrust Washer	PTFE
09	Anti-Static Device	SS316
10	Stem Packing	PTFE
11	Body	A351 CF8M
12	Gland	A351 CF8
13	Locating Piece	SS304
14	Bolt	SS304
15	Ring Washer	SS304
16	Bolt	SS304
17	Handle	A351 CF8